

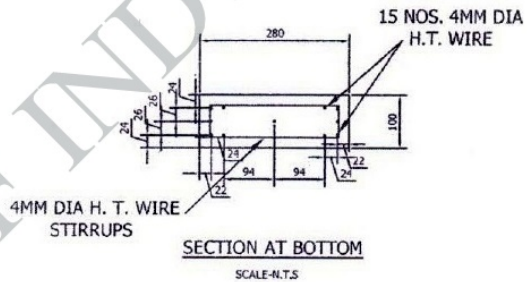

REINFORCEMENT DETAILS OF 8.0M/200 KG

PRESTRESSED CEMENT CONCRETE POLES (FACTORY OF SAFETY = 2.5)

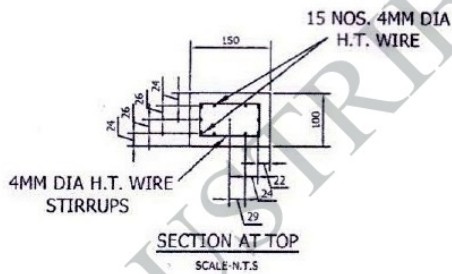
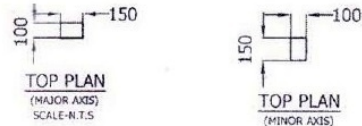
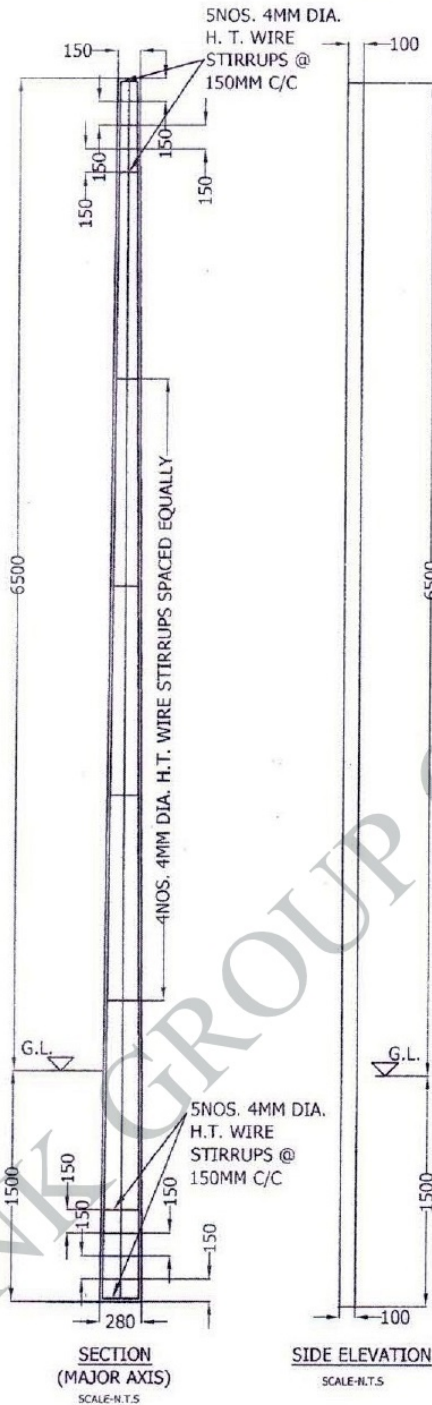

NOTE:

1. WORKING LOAD 200KG ACTING AT 600MM BELOW THE TOP OF THE POLE.
2. FACTOR OF SAFETY = 2.5
3. DEPTH OF PLANTING BELOW G.L. = 1500MM.
4. H.T. WIRE USED 15 NOS. 4MM DIA. HAVING A MINIMUM TENSILE STRENGTH OF 1715 N/SQ.MM AS PER IS 6003.
5. PRETENSION TO BE APPLIED/4MM Ø H.T. WIRE EQUAL TO 1758 KG.
6. 20MM THICK CAPPING WITH 1:2 CEMENT MORTAR OR 3 COAT BLACK ANTI CORROSIVE BITUMINOUS PAINT TO BE PROVIDED AT THE ENDS OF THE POLE.
7. 4MM DIA. H.T. WIRE STIRRUPS ARE TO BE PLACED @ 150MM C/C FOR THE DISTANCE OF 600MM FROM THE TOP & BOTTOM. IN REMAINING CENTRAL POSITION ANOTHER 4NOS. STIRRUPS SHALL BE PLACED IN EQUAL SPACING. TOTAL STIRRUPS EQUAL TO 14NOS.
8. GRADE OF CONCRETE IS M42.
9. ALL DIMENSIONS ARE IN MM.
10. THIS HAS REFERENCE TO THE RESOLUTION OF STANDARDIZATION COMMITTEE MEETING HELD ON 27.02.2018